

Step 6

There is a locking latch on the bottom wall mount only. (Fig 16)

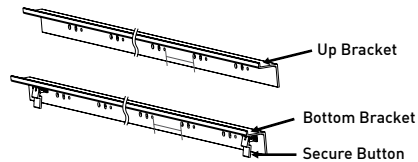

(Fig 16)

Step 7

Fix the mounts onto the wall separately. (Fig 17-18)
(For 95" - height (h) = 1260mm & 105" - height (h) = 1430mm).

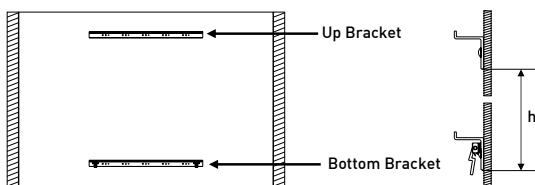

(Fig 17)

(Fig 18)

Step 8

Hook screen onto the top mount and bottom mount. (Fig 19-20)

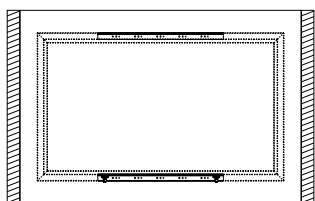

(Fig 19)

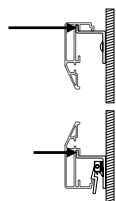

(Fig 20)

Step 9

To uninstall the screen, please press the latch towards the wall to release bottom frame from bottom mount, then lift the screen a little to release it totally from top and bottom groove of the mounts. (Fig 21-22)

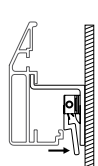

(Fig 21)

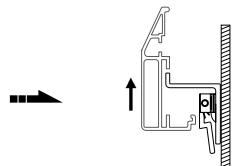

(Fig 22)

Happy Viewing!

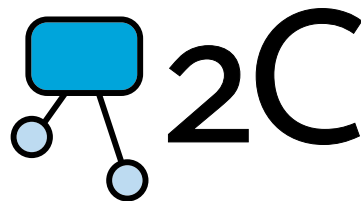

Protecting Your Screen:

- Keep away from direct sunlight or high temperatures.
- Examine both the front and back surfaces before retracting into the case to make sure it is free of dust, dirt, insects or other foreign matter.
- Use a soft brush or cloth to lightly remove any foreign particles.

Cleaning Your Screen:

- Do not use any solvents, chemicals or abrasive cleaners on the screen surface.
- Use a mild detergent with warm water to remove any marks on the surface or screen case.
- Always immediately dab the screen with a soft cloth to avoid soap marks.
- Do not scrub the surface.

Warranty: 12 Months

For more information please go to
www.2cdisplays.com.au
or call 1300 730 025

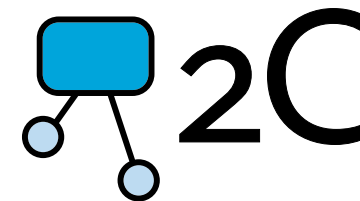

2C Frame IT Cinema
Flocked Frame Screen
Installation Manual

Required (not supplied)

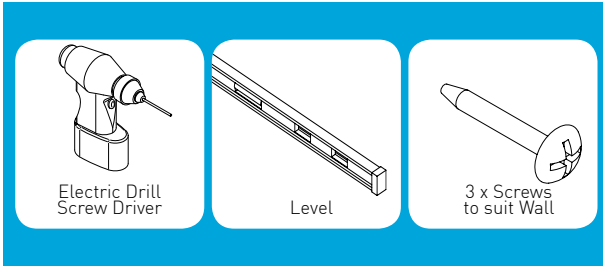

Supplied

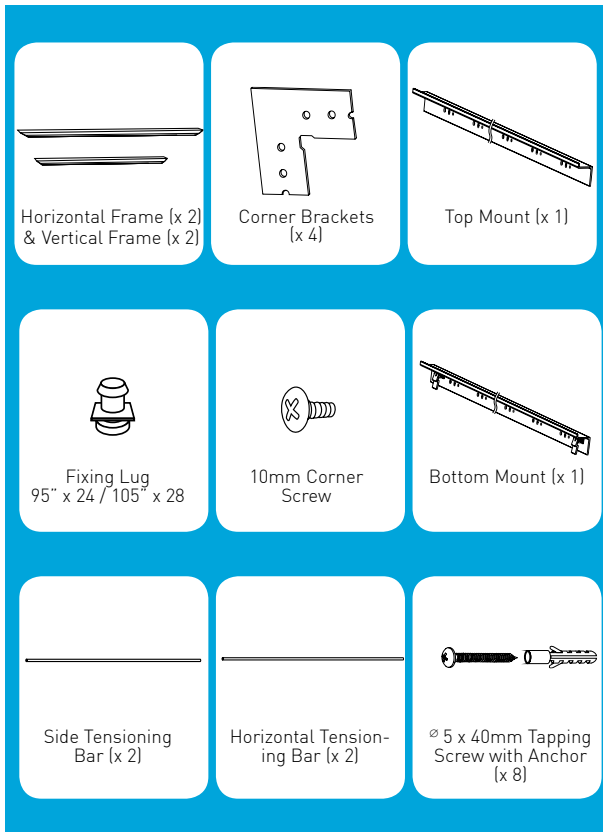

Step 1

Lay each section of the frames on a tidy flat surface. (Fig 1)

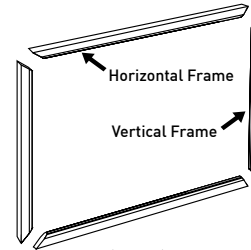

(Fig 1)

Step 2

Slide Fixing Lugs into grooves on the reverse side of frames. (Fig 2 - 3)

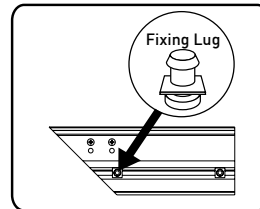

(Fig 2)

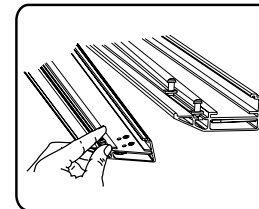

(Fig 3)

Step 3

Insert both horizontal and vertical frame sections with the corner stakes. Ensure all joints are square and then lock off by tightening with the screws provided. (Fig 4-7)

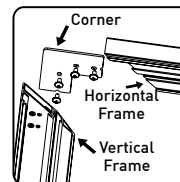

(Fig 4)

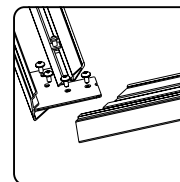

(Fig 5)

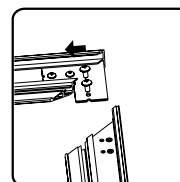

(Fig 6)

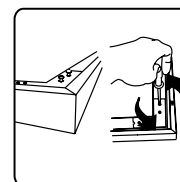

(Fig 7)

Step 4

Unfold screen fabric and insert the tensioning bars into the fabric grooves. (Fig 8-10)

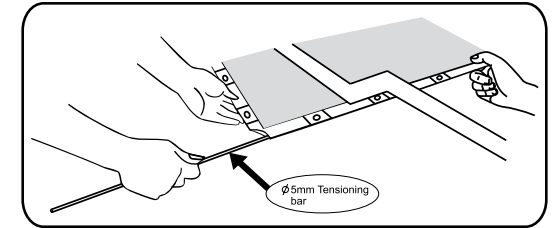

(Fig 8)

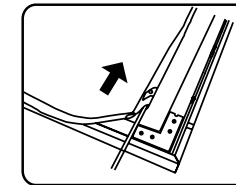

(Fig 9)

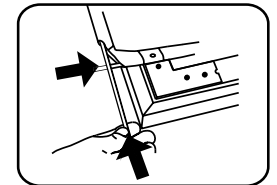

(Fig 10)

Step 5

Align fixing lugs and the eyelets provided on the fabric. Using the tensioning bar, pull fabric eyelets over the lugs. (Tip: Arrange horizontal tensioning bars first then side tensioning bars). (Fig 11-15)

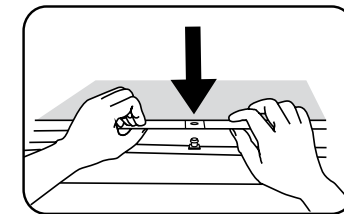

(Fig 11)

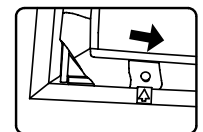

(Fig 13)

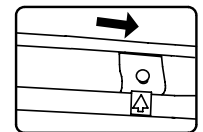

(Fig 14)

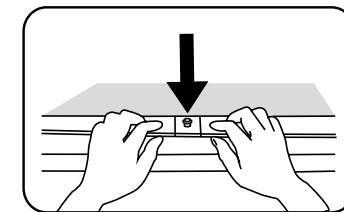

(Fig 12)

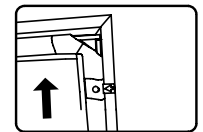

(Fig 15)